

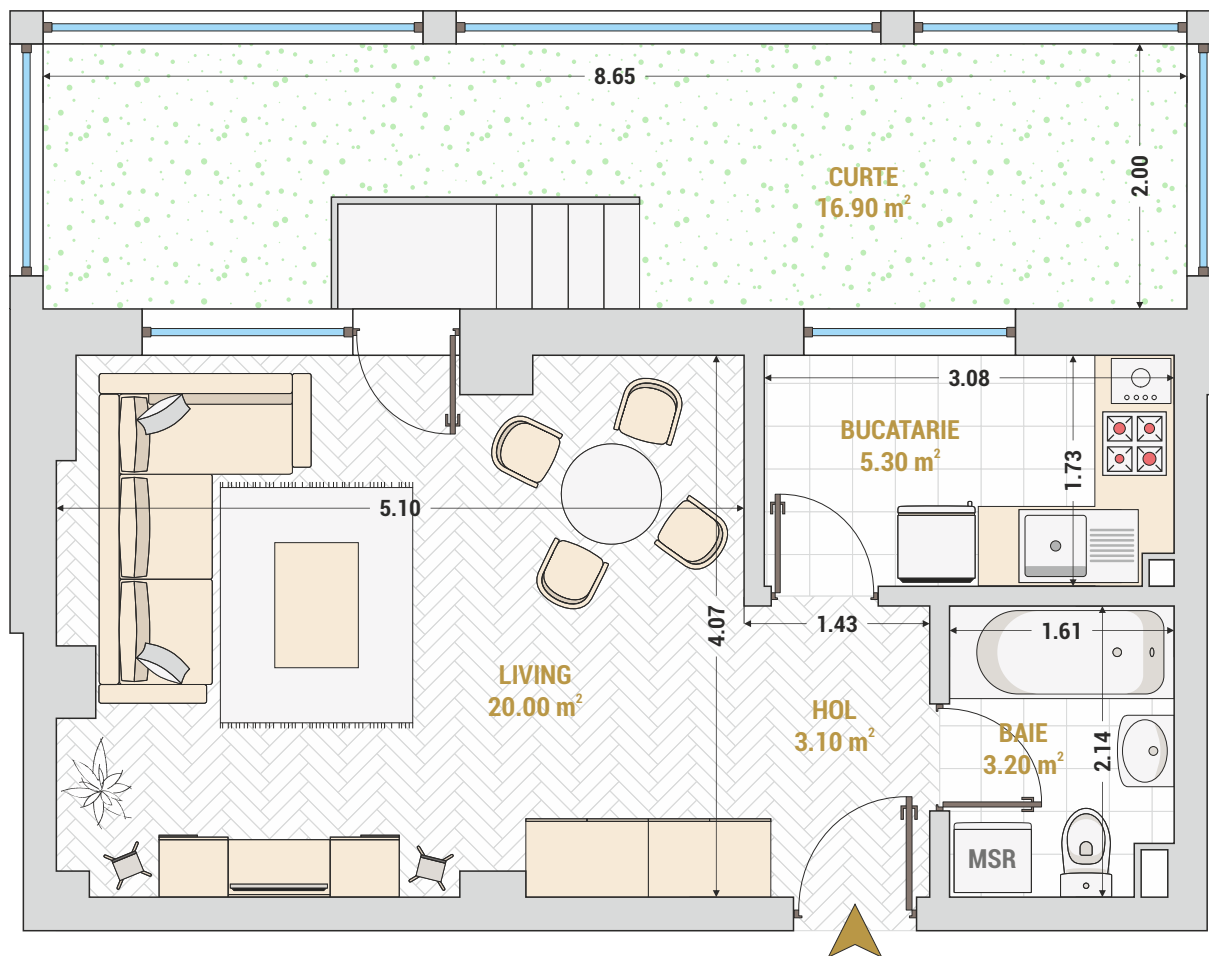

CATEDRAL
RESIDENCE

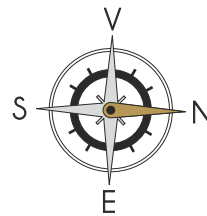



GARSONIERA TIP 7 - TRONSON 1

| | |
|-------------------------|----------------------|
| Living | 20.00 m ² |
| Bucatarie | 5.30 m ² |
| Baie | 3.20 m ² |
| Hol | 3.10 m ² |
| Curte | 16.90 m ² |
| Suprafata utila | 31.60 m ² |
| Suprafata utila + Curte | 48.50 m ² |

DISPONIBILITATE Parter - Nr. 7
Parter - Nr. 8

