

## STRADA

### Handwash basin 45 cm

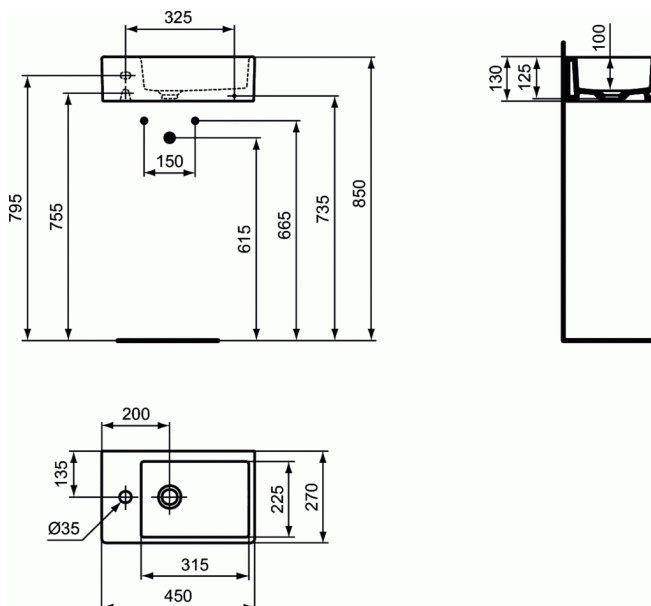

#### Handwash basin 45 cm

Left tap hole punched and without overflow

In carton box

EN 14688

Including: Fixation set

Recommended equipment:

- Fixation set M10 x 140 mm (WW965340)
- Design siphon G1 1/4 (in case of installation without semi-pedestal and without base cabinet) (E0079AA)
- Design stop angle valve (water connection G1/2, connection with mixer 10 mm/ G3/8) - 1 pc (A3491AA)
- Siphon waste G1 1/4 - tubular type (A2305AA)
- Stop angle valve (water connection G1/2, connection with mixer 10 mm/ G3/8) - 1 pc (B7883AA)
- Escutcheon for siphon G1 1/4 (B4801AA)
- Free waste G1 1/4 for basins without overflow (J3291AA)

#### REQUIRED

Free waste G1 1/4

J3291

#### FINISHES\*



01

\* 01 = Euro White